

TECHNICAL DATA

| | |
|------------------------------|--------------------------|
| Exterior Dimensions (WxDxH) | 95.25" x 26.75" x 34.25" |
| Interior Dimensions (WxDxH) | 92" x 23" x 26.25" |
| Net Volume (cu. ft.) | |
| Gross Weight | 430lb |
| Packaging Dimensions (WxDxH) | 101" x 33" x 41.75" |
| Electrical Cord Length | |
| Capacity | 27.5 cu. ft. |
| # 12 oz. Bottle Cases | 37.5 |
| # 12 oz. Can Cases | 55 |

Cooling

| | |
|------------------------|-------------|
| Temperature Range | 33° - 41° F |
| Refrigerant | R-290 |
| Maximum Ambient Temp | 90° F |
| Maximum Humidity | 65% |
| Defrosting | Automatic |
| Cooling System | |
| Temperature Display | |
| Temperature Controller | Electronic |
| H/P | 1/4+ |

Construction

| | |
|---------------------|---|
| Exterior Material | Stainless Steel Top, Black Vinyl Finish |
| Insulation Material | |
| Shelf Material | Coated steel |
| Shelf Load Capacity | |

Electrical

| | |
|---------|----------|
| Voltage | 115/60/1 |
| Amps | 4.2 |

PLAN VIEW

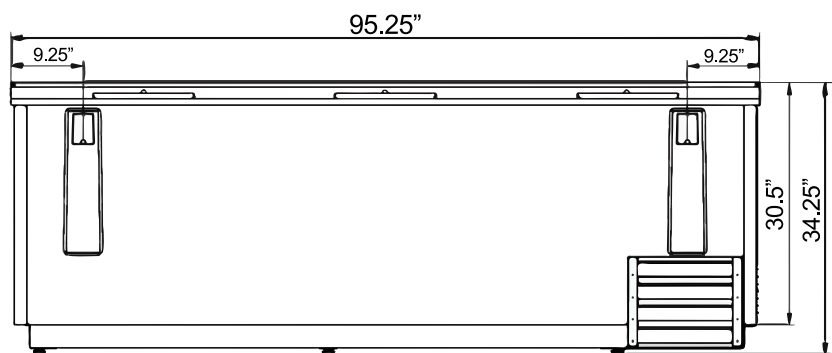

Front View

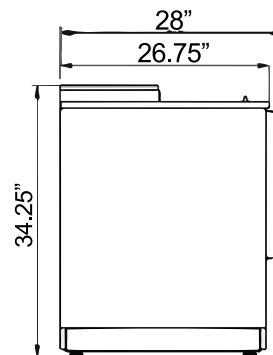

Side Views

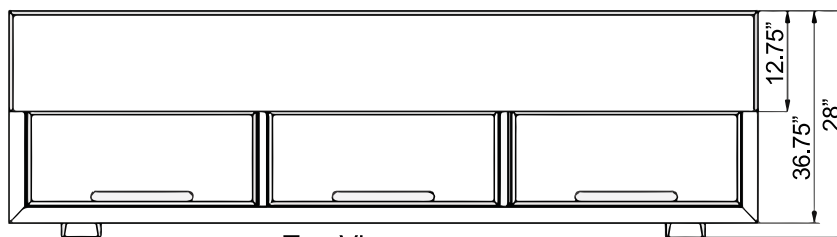

Top View

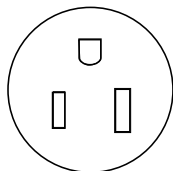
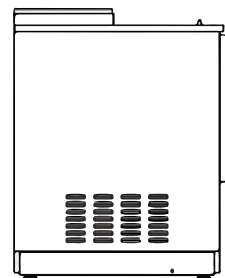

NEMA 5-15P